

CASA DE LOS PATIOS

Lot 6

- Enclosed living area: **2,098.96 ft<sup>2</sup> (195 m<sup>2</sup>)**
- Total construction: **2,801.31 ft<sup>2</sup> (260.25 m<sup>2</sup>)**
- Lot size: **2,244.5 ft<sup>2</sup> (208.52 m<sup>2</sup>)**
- Large central atrium
- View point tower
- 3 bedrooms, 3.5 baths
- Corner lot on central plaza with view of church and open field

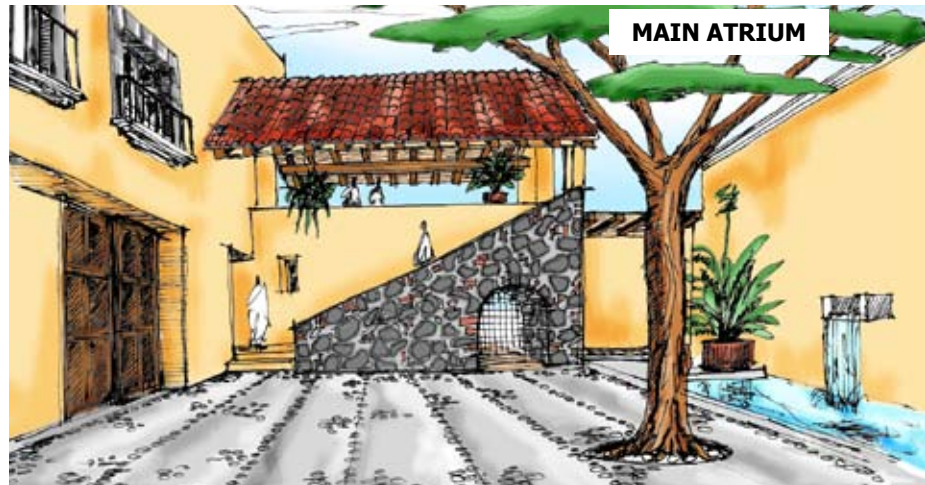

LOT 5 →

